

STUDIO C

A professional recording studio with blue acoustic panels, mixing consoles, and computer monitors. The room is dimly lit with blue ambient lighting. In the foreground, there are black office chairs and a desk with a mixing console. In the background, there are more mixing consoles, monitors, and a door with a green exit sign. The ceiling has blue and white acoustic slats.

AT METROPOLIS

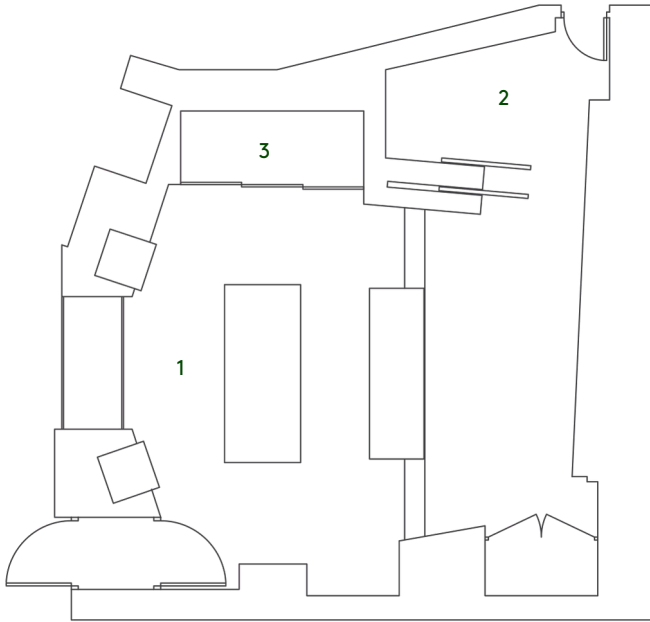

- 1. Control Room 19m2
- 2. Overdub Booth 9m2
- 3. Machine Bay 3m2

Equipment

- SSL 6032 G-Series Console with CML ABC buses and Metropolis custom modifications. Malcolm Toft MPower PSU
- THD-Labs Tangerine Automation Interface
- Avid S1 Control Surface
- Prism ADA-128 - 40io
- Burl B2 Bomber
- Pro Tools HDX2
- Logic X
- PMC BB5/XBD Active Main Monitoring System
- Yamaha NS10
- Genelec 8351a
- Bryston and Quad Amplifiers
- iconnectivity MioXL MIDI interface
- Pultec EQH 2
- Pultec MEQ 5
- Summit EQ-F100
- AMS RMX-16
- Bricasti M7
- EMT 244 Reverb
- Lexicon 480L
- EMT Plate Reverbs (available on request)
- Pioneer SR202
- Roland DimD
- Roland SDE-3000
- Ensoniq DP/4+
- Instruments
- Roland Juno 106
- Arturia Matrix Brute
- Novation Peak
- Novation Bass Station 2
- Roland TR-8S
- Roland TB-03
- Roland TR-08
- Roland TR-09
- Moog Subsequent 37
- Rickenbacker 4003S Bass Guitar
- Upright Piano
- Martin D-10 Acoustic Guitar

Outboard Including

- Neve 1073 Classic
- AI Smart C1 Stereo Compressor
- DBX 160 Compressor
- Empirical Labs Distressors EL8-X (with British Mode)
- Neve 33609
- Prism Maselec MLA-2
- Tube Tech CL-1A
- Urei 1176 Silver Face
- GML 8200
- Prism Maselec MEA-2